



## Portland's Creative Industrial Community

*Courtesy to brokers*

- 8'-FT LED lighting fixtures throughout.
- Water supply stubbed into space.
- Natural gas available.
- Double door entry suitable for forklift access.
- Easy access to exterior loading.
- Fully sprinklered.
- Concrete floor and ceiling.
- Approx. 9' clear ceiling.
- Bottom of truss is 12'-6" clear of the floor



**Unit G05** Available Now

\$3000/mo gross

[inquiries@generalindustry.com](mailto:inquiries@generalindustry.com)

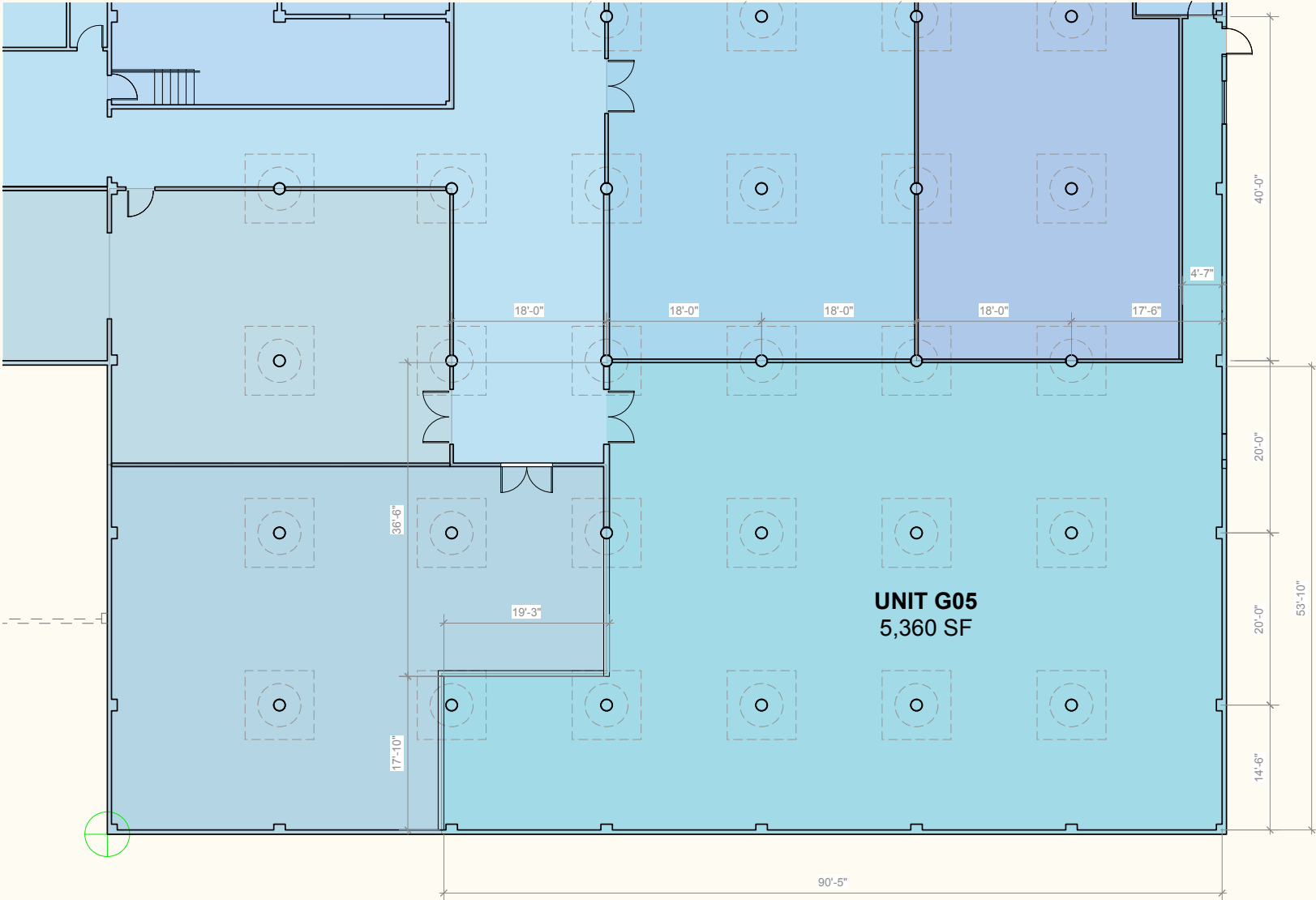

© 2023 GENERAL INDUSTRY. SUBJECT TO CHANGE WITHOUT NOTICE

**Unit G05** Available Now

\$3000/mo gross

[inquiries@generalindustry.com](mailto:inquiries@generalindustry.com)